

Transfer Application Guide.

Items required:

An ammonia based, liquid window cleaner.



A plastic/silicone squeegee or any similar object/material having all smooth, rounded, (not sharp), edges.



Quality scissors/a utility knife blade or scalpel.



A quality, absorbent lint free rag or cloth.

(a high G.S.M/thick cotton T-shirt, bed sheet portion or Singlet/Tank top is perfect).

*I sometimes refer to the clear Transfer/Application tape as "app tape"

*Vinyl Sticker/Transfer/Symbol and Decal are the same thing.

Step 1: Examine your item. The sticker may appear to have blemishes or smudges whilst still in its protective sleeve. It also has a layer of plastic application tape on top of the vinyl transfer.



> Once these two layers of plastic are removed and the transfer has been given its final, gentle clean, it will appear faultless! 8-)

Step 2: Using your scissors, blade or sharp instrument, *carefully* remove the sticker from its protective sleeve.



Step 3: Thoroughly clean and dry the surface where you intend to place your sticker.

Do your best to ensure the surface **is** in fact, lint dust & dirt free. (I personally use a soft blast of compressed air as a guarantee).

Step 4: Place the transfer on a flat, solid surface and gently, (but firmly), squash the entire thing flat.

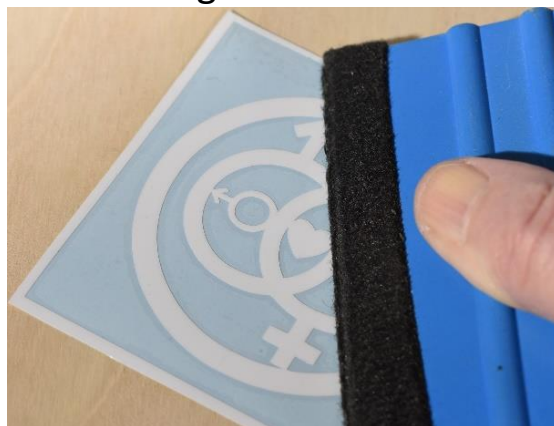

*We need to squash it well before attempting to remove the backing paper & apply the transfer to the intended surface.

This is done to ensure the transfer tape & vinyl sticker are stuck together to remove them, (as one), from the backing paper.

Step 5: Ensure your transfers symbol is oriented correctly/facing to the top.

Step 6: We then begin to separate the topmost/application tape and vinyl transfer from the backing paper in one top corner.

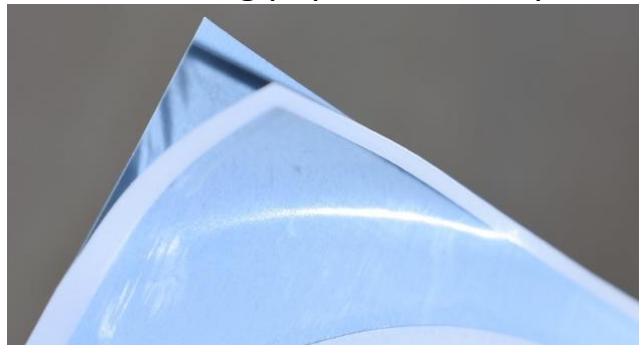

***Tip:** The inner edges of the outside vinyl border are perfectly square with the symbol itself. Use these to align your sticker exactly how you want it. (The outer edges are cut by hand and may not be perfectly square).

Step 7: Carefully extend this separation across the entire top edge of the transfer.



What you should have now is a "hinge" of clear transfer tape. Peel the transfer tape downwards evenly until your "hinge" measures about 10mm.

***In the following pictures I am using a clear pane of glass on the surface of a wooden bench for demonstration purposes.**

***Please do not crease or fold stickers with reflective or decorative finishes as this action will leave unsightly visible faults on the stickers surface. We can and DO fold the app tape and backing paper layers ONLY.**

Step 8: Now we fold the beginning of the backing paper back over itself & the transfer tape/decals. (to the left).

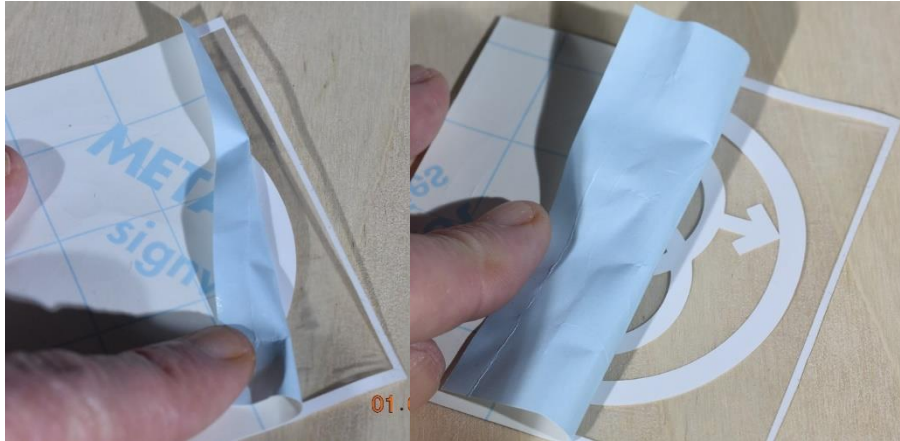

-> The goal here is to remove the backing paper entirely, (very slowly and carefully), leaving the combined clear transfer tape and vinyl decal as one.

*To assist in the removal process you can place the fingers of your other hand anywhere on the clear transfer tape to anchor it as you roll the backing paper to the left <-, but NOT on the vinyl transfers adhesive surface itself.

Step 9: As you roll the backing paper off, pay CLOSE attention to any lifting of the smaller elements of the vinyl symbol as you carefully & slowly continue to remove the backing paper.

***If any of the smaller elements of the symbol begin to lift? Move the backing paper back over that small section & squash it flat again.**

***If it continues to lift? -> Change the direction in which you are removing the backing paper.**

Eg: The removal direction is changed, becoming opposite to the direction of the smaller elements of the symbol that might come away from the application tape clear layer.

Step 10: Ensuring the correct alignment of the transfer, offer the transfer, (complete with application tape), up to its intended surface and carefully stick the top/"hinge" to your glass/paint surface.



Step 11: Using the squeegee, or rounded edge silicon/plastic utensil, we smooth the transfer from top to bottom, using firm pressure to eliminate any air bubbles or pockets that may form.



IMPORTANT! Using your spare fingers - ensure you keep even tension on the complete lower half of the sticker to eliminate the risk of folds, creases or bubbles.

TIP: I am using gravity alone in the above image, (no tension on the sticker). You can see the right hand side has a slight lift or “hump” in the transfer/app tape? that could easily become a crease or fold if I were not very careful.

Why? Because I needed to press the camera shutter button with my other hand! 8-)

Step 12: Once again, we firmly squash the combined application tape & sticker flat, to ensure the Vinyl transfer remains stuck to our surface.

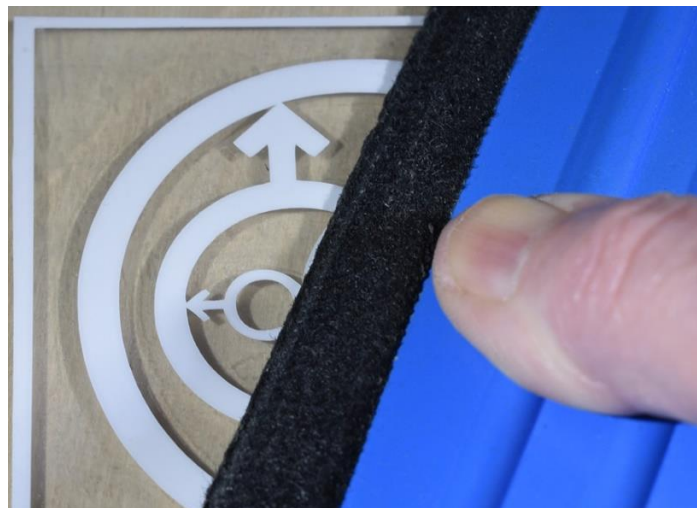

Step 13: Now you can remove the app tape from your sticker!. Carefully prise the app tape edge, (& vinyl outer border), from the surface and begin to peel it off the symbol.



IMPORTANT: Fold the app tape directly back on top of itself to minimise the chances of the finer elements of the symbol from lifting off the surface.

If any part of the transfer begins to lift?

Move the app tape back over that section and squash it down firmly again.

If sections of the transfer continue to lift as you try to remove it?

Change the angle at which you are attempting to remove the application tape.

Eg: from left to right instead of downwards? or whichever way works best for that particular sticker design.



Almost done..

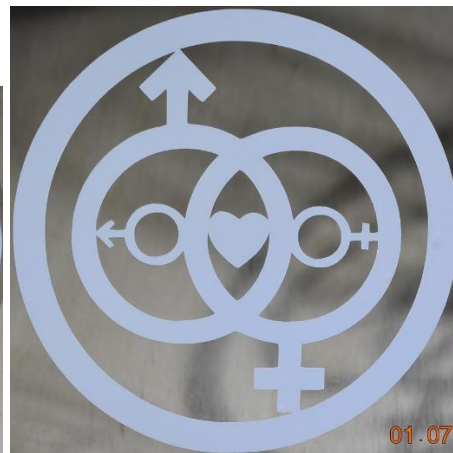

Complete!

Using your liquid cleaner and quality cloth, clean the sticker and surface by carefully dabbing it.

DO NOT rub it vigorously as you might lift some of the finer sections of the symbol.

CONGRATULATIONS! & ENJOY *\\0/*

Kind regards <-> PKJM Fine Art.